

Owner's Manual Additional Information

Page 103: New function for "9-Tuning a Musical Instrument (Tuner)"

The tuner is now easier to use.

When the TUNER screen is open, you can press the **PLAY** button to reverse the screen orientation, making it easier to tune using the built-in mic.

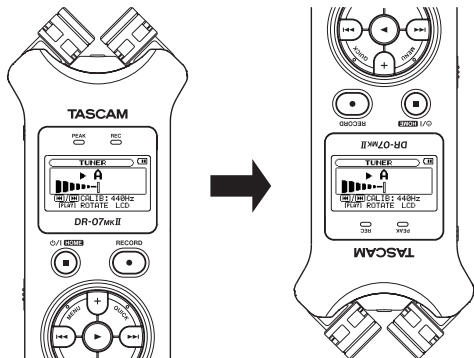

Owner's Manual Correction

Page 109: Revisions in "Turning the unit power OFF automatically"

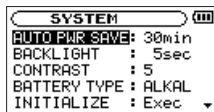

- Revision of the automatic power saving setting item name

Correct: AUTO PWR SAVE

Incorrect: AUTO OFF

- Change to the factory setting

Correct: Options: OFF, 3min, 5min, 10min, 30min (factory setting)

Incorrect: Options: OFF (factory setting—the unit does not automatically turn OFF), 3min, 5min, 10min, 30min